

Cam & Groove Configurations

Configurations are representative of the Dixon® line of cam & groove.

B



Type A
adapter x female NPT



Type E
adapter x hose shank

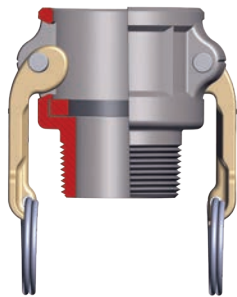

Type B
coupler x male NPT

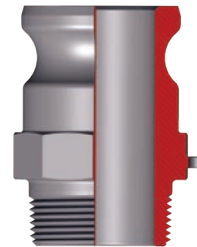

Type F
adapter x male NPT

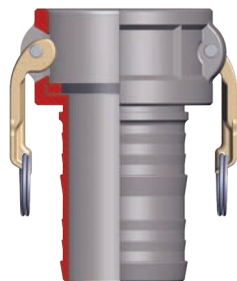

Type C
coupler x hose shank

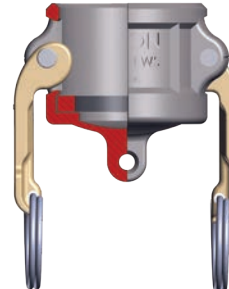

Type DC¹
dust cap

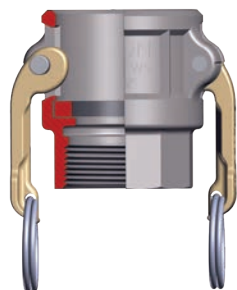

Type D
coupler x female NPT



Type DP¹
dust plug



¹ Dust caps and dust plugs are not to be used in pressure applications for safety and environmental reasons.

⚠ WARNING

Under no circumstances should cam & groove couplings be used for compressed air or steam service!